

成品580*210

FUTURE CALL

PICTURE DIALER BOX WITH SPEAKERPHONE ONE TOUCH DIALING

MODEL: FC-2409-2



USER MANUAL

- Please follow instructions for repairing if any otherwise do not alter or repair any parts of device except specified.

IMPORTANT SAFETY INSTRUCTIONS

Before using your Picture Dialer Box, basic safety precautions should always be followed to reduce the risk of fire, electric shock and injury to persons including the following:

1. Read and understand all instructions.
2. Follow all warnings and instructions marked on the product.
3. Unplug this product from the wall outlet before cleaning. Do not use liquid or Aerosol cleaners. Use a damp cloth for cleaning.

4. Do not use this product near water, for example, near a bath tub, wash bowl, kitchen sink, or laundry tub, in a wet basement or near a swimming pool.
5. Do not place this product on an unstable cart, stand, or table. The product may fall causing serious damage to the product.
6. Slots and openings in the enclosure and the back and bottom are provided for ventilation, to protect it from overheating. These openings must not be blocked or covered. The openings should never be blocked by placing the product on a bed, sofa, rug, or other similar surface. This product should never be placed near or over a radiator or heat register. This product should not be placed in a built-in installation unless proper ventilation is provided.
7. This product should be operated only from the type of power source indicated on the marking label. If you are not sure of the type of power supply to your home, consult your dealer or local power company.
8. Do not allow anything to rest on the power cord. Do not locate this product where the cord will be abused by persons walking on it.
9. Do not overload wall outlets and extension cords as this can result in the risk of fire or electric shock.
10. Never push objects of any kind into this product through cabinet slots as they may touch dangerous voltage points or short out parts that could result in a risk of fire or electric shock. Never spill liquid of any kind on the product.
11. Do not disassemble this product, but take it to a qualified service technician or service center when repair work is required. Opening or removing covers may expose you to voltage or other risks. Incorrect reassembly can cause electric shock when the appliance is subsequently used.
12. Unplug this product from the wall outlet and refer to qualified service personnel under the following conditions:
 - A. When the power supply cord or plug is damaged or frayed.
 - B. If liquid has been spilled into the product.
 - C. If the product has been exposed to rain or water.
 - D. If the product does not operate normally by following the operating instructions. Adjust only those controls that are covered by the operating instructions. Improper adjustment of other controls may result in damage and may require extensive work by a qualified technician to restore the product to normal operation.
 - E. If the product has been dropped or the enclosure has been damaged.
 - F. If the product exhibits a distinct change in performance.
13. Avoid using a telephone during an electrical storm. There may be a remote risk of electric shock from lightning.
14. Do not use the telephone to report a gas leak in the vicinity of a leak.
15. Never install telephone wiring during a lightning storm.

16. Never install telephone jacks in wet locations unless the jack is specifically designed for wet locations.
17. Never touch uninsulated telephone wires or terminals unless the telephone line has been disconnected at the network interface.

SAVE THESE INSTRUCTIONS

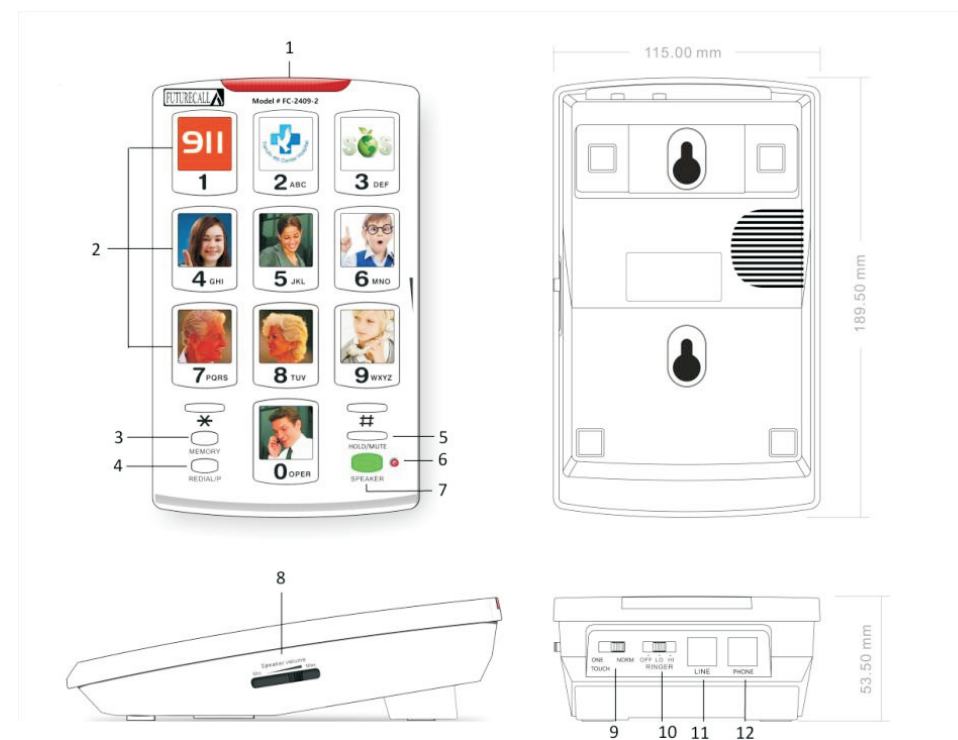

| | | | |
|---|--------------------------------------|----|--------------------------------|
| 1 | Ringer Light | 7 | Speakerphone |
| 2 | Dialing Keypad/ Memory keys (0-9) | 8 | Slide Speaker Volume Switch |
| 3 | Memory key | 9 | One Touch/Normal Switch |
| 4 | Redial/Pause key | 10 | Ringer OFF-LOW-HI Switch |
| 5 | HOLD/MUTE key | 11 | LINE Socket |
| 6 | IN USE Light | 12 | PHONE Socket |

INSTALLATION

Line Cord Connection

1. Insert 1 the straight cable directly into the line socket at the rear side of base unit, and then insert the other end into the wall jack.
2. If you have a telephone you wish to connect you can plug it into the phone socket at the rear side of base unit,

MEMORY FEATURE

To Program

Your DIALER BOX is equipped with ten 2 touch memory keys for programming your most frequently dialed telephone numbers.

1. Slide the Normal / One touch Switch to NORMAL position.
2. Enter the phone number you wish to store including area code if needed.
3. Press and hold for the Memory key for 5 seconds
4. Press the (0-9) (Pictures) keys where you want that telephone number stored in
5. Your number is now stored.

To change a stored number, repeat the same process 1-5. The new number will be stored and the old number will be removed...

OPERATION

KEY FEATURE

Last Number Redial / Pause

Your DIALER BOX remembers the last number dialed. If the number you dial is busy or not being answered, press the speaker key to hang up. Then to redial the last number press the speaker key then REDIAL key the number will dial out

NOTE: You can redial the same telephone number as many times as required. However, once you dial another number, the previous number is erased. **This key is also used as a pause key when programming this phone on a PBX system. E.G... "9" before the number**

Ringer Switch OFF-LO-HI and Ringer LED Lights

Your dialer box provides an off-lo-hi switch, when you don't want to be disturbed, slide the switch to the off position. Now you can still make outgoing calls without being disturbed by incoming calls. The ringer LED lights will still flash even if the off-lo-hi switch is in the off position.

NORMAL – ONE TOUCH SWITCH

This switch is used to switch between Normal and One touch dialing

SLIDE SPEAKER VOLUME SWITCH

This switch is used to slide the speaker volume from minimum to maximum.

HOLD/ MUTE KEY

This key is for music on hold / Mute when you're talking to someone. To use when talking press the hold key you will hear music press again to turn off.

MEMORY KEY

This key is used when storing numbers into the memory and dialing out from the memory in normal mode.

To Dial a Normal number

You can push the speakerphone key then dial the number you want using the (0-9) key.

To Use this Dialer Box with another telephone

When this dialer box is connected with another telephone can be used in the following ways.

1. When you're talking to someone using this dialer box on speaker mode, now if you want to talk in private, you can just pick up the handset of telephone and the speakerphone of dialer box will be cut off automatically, now you can use the handset to talk in private,

2. When you're talking to someone using the handset of the telephone and if you want to talk in public, you can push the speakerphone key of dialer box and then hang up the handset, now the call is on speaker mode again, you can talk in public using the dialer box now.

To Dial Memory Numbers

Your unit provides the option of "Normal" or "One Touch" dialing mode.

Normal mode - To retrieve numbers stored in the key button (0-9) (Pictures) Push the speakerphone key and press and release the MEMORY key. Then press the keys number (0-9) (Pictures) which stores the telephone number you want to dial. Your call will be automatically dialed.

One Touch mode - To retrieve numbers stored in the key button (0-9) (Pictures)

Push speakerphone key then press one of the keys (0-9)(Pictures) which store the telephone number you want to dial. Your call will be automatically dialed.

CONSUMER INFORMATION

This equipment complies with Part 68 of the FCC rules and the requirements adopted by the ACTA On the bottom of this equipment is a label that contains, among other information, a product identifier of US: 4VKTE0913FC1007 If requested, this number must be provided to the telephone company.

The applicable jacks (i.e. RJ11C) for this equipment are provided in the packaging with each piece of approved equipment. The jacks are certified by Universal Service Order Codes (USOC).

A plug and jack used to connect this equipment to the premises wiring and telephone network must comply with the applicable FCC Part 68 rules and requirements adopted by the ACTA. A compliant telephone cord and modular plug are provided with this product. They are designed to be connected to a compatible modular jack that is also compliant. See installation instructions for details.

The REN is used to determine the number of devices that may be connected to a telephone line. Excessive RENs on a telephone line may result in the devices not ringing in response to an incoming call. In most but not all areas, the sum of RENs should not exceed five (5.0). To be certain of the number of devices that may be connected to a line, as determined by the total RENs, contact the local telephone company. [For products approved after July 23, 2001, the REN for this product is part of the product identifier that has the format US:AAAEQ##TXXXX. The digits represented by ## are the REN without a decimal point (e.g., 03 is a REN of 0.3). For earlier products, the REN is separately shown on the label.]

If this equipment FC-2409-2 causes harm to the telephone network, the telephone company will notify you in advance that temporary discontinuance of service may be required. But if advance notice isn't practical, the telephone company will notify the customer as soon as possible. Also, you will be

advised of your right to file a complaint with the FCC if you believe it is necessary.

The telephone company may make changes in its facilities, equipment, operations or procedures that could affect the operation of the equipment. If this happens the telephone company will provide advance notice in order for you to make necessary modifications to maintain uninterrupted service.

If you experience trouble with this equipment, disconnect it from the network until the problem has been corrected or until you are sure that the equipment is not malfunctioning.

Please follow instructions for repairing if any (e.g. battery replacement section); otherwise do not alter or repair any parts of device except specified. Connection to party line service is subject to state tariffs. Contact the state public utility commission, public service commission or corporation commission for information.

This equipment is hearing aid compatible.

NOTICE : If your home has specially wired alarm equipment connected to the telephone line, ensure the installation of this equipment FC-2409-2 / FC-1007 does not disable your alarm equipment. If you have questions about what will disable alarm equipment, consult your telephone company or a qualified installer.

WARNING : Changes or modifications to this unit not expressly approved by the party responsible for compliance could void the user's authority to operate the equipment.

SERVICE

According to FCC regulation. This equipment which has been certified and registered by the FCC, may only be repaired by authorized person, the FCC certification may be voided. Should you encounter any problems, please call the FUTURE CALL LLC.

Toll-free Customer Hotline for assistance:

1-888-934-CALL, Monday - Friday between the hours of 9:00 am - 6:00 pm PST

For general inquires, you can E-Mail to futurecall@onvol.net or visit our website at www.future-call.com

FOR WARRANTY AND OUT-OF WARRANTY SERVICE:

You may call our toll-free hot line on 1-888-934-CALL (1-888-934-2255) 9AM-6PM PST or E-mail to help@future-call.com

QUESTIONS?

**STOP...doesn't take unit back to the store.
LOOK...for the toll-free "help" telephone number.**

LISTEN... as our experts talk you through the problem.

For immediate answers to your questions regarding operation, missing parts or installation call:

**FUTURE CALL LLC
HOTLINE & E-MAIL AT:
1-888-934-CALL & help@future-call.com**

LIMITED WARRANTY AND SERVICE

FUTURE CALL LLC. warrants this product to be free from defective materials or factory workmanship and will replace or repair this unit or any part thereof, except batteries, if it proves to be defective in normal use or service within 90 days from date of original purchase. Our obligation under this warranty is the repair or replacement of the defective instrument or any part thereof, except batteries. This warranty will be considered void if unit is tampered with, improperly serviced, or subjected to misuse, negligence or accidental damage. There are no other express warranties other than those stated herein. This warranty gives you specific legal rights, and you may also have other rights which varies from state to state. TO OBTAIN SERVICE PLEASE E-MAIL US ON help@future-call.com OR CALL US TOLL FREE 1-888-934-CALL 9AM-6PM PST (1-888-934-2255). IF THE UNIT IS UNDER WARRANTY PROOF OF PURCHASE MUST BE PROVEN.